

# John F. Savage Arena Promoters Guide



# Table of Contents

---

General Information	pg 1
Key Contacts	pg 2
Parking	pg 3
Directions	pg 4
Technical Information	pg 5
Arena Layouts	pg 6
Dressing Rooms	pg 8
Media	Pg 9

# General Information

---

## History

John F. Savage Hall enters its 33<sup>rd</sup> year as the home of Rocket basketball, and its first since the completion of a \$30 million renovation that has made the University of Toledo athletic facility one of the finest arenas in the country. The renovation and expansion of Savage Arena and the adjoining Charles A. Sullivan Athletic Complex debuted in November. Originally known as Centennial Arena when it was built in 1976, the arena was renamed “Savage Hall” in 1988 and then became “Savage Arena” this past year as part of the renovation project.

Designed by architectural firms of SSOE, Inc. and Ellerbe Becket, the new Savage Arena includes a new “bowl-style” seating configuration that will bring fans closer to the action. Seating capacity for basketball is 7,300. Among the other improvements to the arena are the addition of a suites, loges and club seats along the west side of the arena a new jumbo video scoreboard and sound system; new lighting; new restrooms and concession stands; a remodeled Joe Grogan Room, a glass-enclosed lounge with seating for up to 200 dinner guests; new locker rooms and team rooms; and a new athletic training room, complete with two whirlpool and the latest in treatment and rehabilitation equipment.

Adjoining Savage Arena is the brand-new Sullivan Complex, a 36,000 square-foot building that serves as the perfect complement to the new arena. Highlighting the Sullivan Complex is the beautiful new glass atrium lobby that serves as the primary entrance into Savage Arena. Other features include a new ticket office; the “RocketShop” for the sale of UT merchandise on game day and during normal business hours; a brand-new Varsity ‘T’ Hall of Fame; the Downtown Coaches “Wall of Champions”; a new 10,000 square-foot strength and training center for UT student-athletes; and new offices for coaches and staff.

A multi-purpose complex, Savage Arena not only serves the needs of intercollegiate athletics, but it also hosts concerts, convocations and graduation exercises. To date, nearly eight million people have visited Savage Hall for various forms of entertainment.

The list of entertainers who have performed in Savage Arena include Elvis Presley, Cher, Pearl Jam, Smashing Pumpkins, Kenny Chesney, Sheryl Crow, TLC, Boyz II Men, Elton John, Frank Sinatra, Michael Bolton, Rod Stewart, Bob Seger, Steve Winwood and many others.

# Contact and Booking Information:

---

## Booking and External Events Manager:

Brian Kantz 419.530.8759 [brian.kantz@utoledo.edu](mailto:brian.kantz@utoledo.edu)

## Key Building Contacts

### Operations Staff:

**Asst. AD Events Operations:** Tim Warga 419.530.2104 [tim.warga@utoledo.edu](mailto:tim.warga@utoledo.edu)  
**Operations Manager:** Tim Ruch 419.530.4338  
**Events Manager:** Chris Barnhardt 419.530.7901

### Ticket Office:

**Dir. Ticket Sales and Service:** Justin Morelli 419.530.5124 [justin.morelli@utoledo.edu](mailto:justin.morelli@utoledo.edu)  
**Manager - Ticket Operations:** Matt Frey 419.530.5310 [matthew.frey@utoledo.edu](mailto:matthew.frey@utoledo.edu)

### Athletic Staff:

**Deputy Athletic Director/External Affairs:** Al Tomlinson 419.530.2127 [alfred.tomlinson@utoledo.edu](mailto:alfred.tomlinson@utoledo.edu)





# Parking

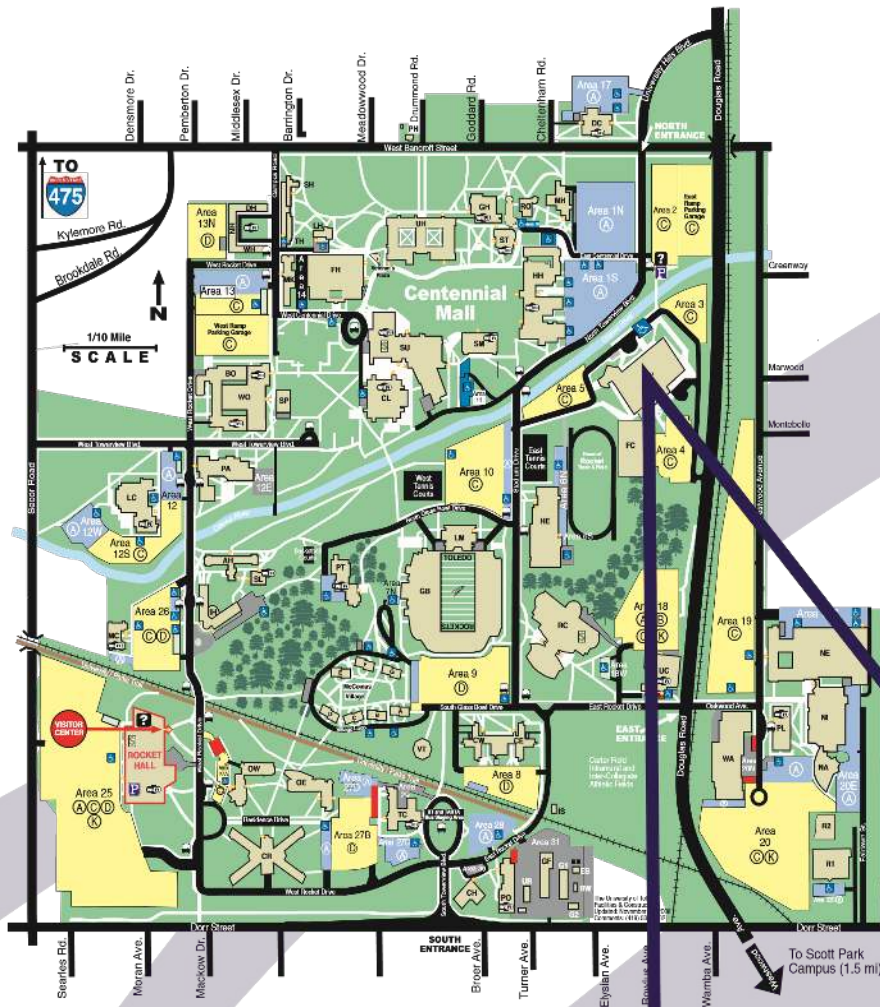

All parking areas are illuminated

Total parking spaces  
(including ADA): 7,831

Complimentary public shuttle service

Per vehicle public  
parking charge: \$5.00





# Directions

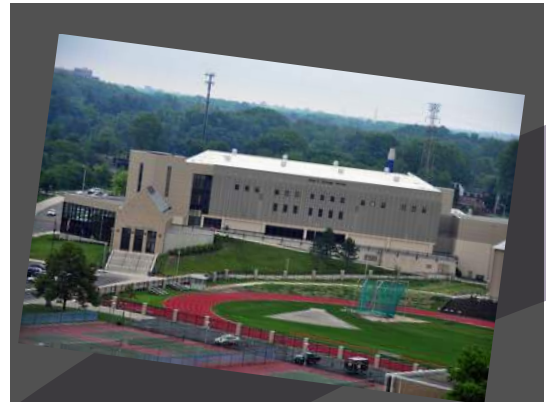

## BY CAR

**A) From the east (Cleveland)** - Ohio Turnpike Exit 59; I-75 north to I-475 west, exit at Douglas Road; Turn left on Douglas and proceed to East Rocket Drive; right on East Rocket Drive into campus.

**B) From the south (Dayton/Columbus)** - I-75 North To I-475 west; exit at Douglas Road; turn left on Douglas and proceed to East Rocket Drive right on East Rocket Drive into campus.

**C) From the North (Detroit/Ann Arbor)** - (F Detroit) I-75 south to I-475 west, exit at Douglas Road; turn left on Douglas and proceed to East Rocket Drive, right on East Rocket Drive into campus. (From Ann Arbor) US-23 south to I-475 east, Exit at Secor Rd. and turn right on Secor, turn Left at Central Avenue; turn right on Douglas Road, Right on East Rocket Drive into campus.

**D) From the west (Chicago)** - Ohio Turnpike to Exit 64, Reynolds Road north to Dorr Street, right on Dorr; left at Douglas; right on East Rocket Drive into campus.





# Technical Information

---

## Seating

Basketball config: 7000

Center stage: 360 degree : 7800

End Stage 180 degree: 5500

½ house: 3000

## Staging Accommodations

64'w x 48'd

## Electric

Location: Upstage Right

Distance: 30'

200 amp (3-phase): Sound

400 amp (3-phase): Video

600 amp (3-phase): Lighting

600 amp (3-phase): Lighting

## Labor Assets

Ushers, Ticket Takers, Event Staff Security, Uniform Police, Ticket Sellers, Runners, Pro Labor (IASTE Local 24), On-site Electricians, Air Quality Technician, Fork-lift Operator, Maintenance Arena Audio & Video Technicians.

## Arena Assets

Loading area: 12'x12' overhead door 40' off of stage left

Shore power: 30amps

Clear Comm: 8 sets, 12 drops (spotlights, FOH mix, Stage monitor, House light position, in-house audio, in-house video).

Elevators: 2 public, 1 service

Turnstiles: 12 Perry Turnstiles

House lighting: Musco sports lighting with instant shuttering capability

Bike Rack: 80'

Cable ramps: 15 @ 36"

Spotlights: 2

In-house video production capabilities

4 side video board

Public Restrooms: 13 women, 7 men, 2 family

Ample storage for dead cases

Assisted listening devices

# Technical Information

---

## Ticketing

The University of Toledo Athletic and special ticket office is a fully functional computerized ticket operation located in the Charles A. Sullivan Complex of Savage Arena. Normal operating hours are Mon-Fri 8:30-5:00. Additional hours are available on weekends and evenings depending on scheduled events. The ticket office staff consists of 2 full time Ticket Operations Manager and 7-10 part time ticket sellers. The part time sellers are UT. acceptable forms of payment are cash, MC/VISA. We sell tickets for multiple events in Savage Arena and the Glass Bowl Stadium. Our current ticket software provider is Paciolan which is a full-feature in-house ticketing system

## Catering

In-house catering services provided by Chartwell's catering.  
On-site kitchen area and catering areas.

## Concessions

Chartwell' concessionaire offers 3 large permanent stands with 16 total points of sale.  
Can also provide portable stands.

## Rigging

Distance to Low Steel - 56'

Savage Rigging Analysis / Truss load diagram available upon request in CAD format.

## Rent

Full House	\$6,000.00 or 12% of gross (whichever is greater)
Half House	\$3,500.00 or 12% of gross (whichever is greater)

# BASKETBALL SEATING

↖ To Ticket Office

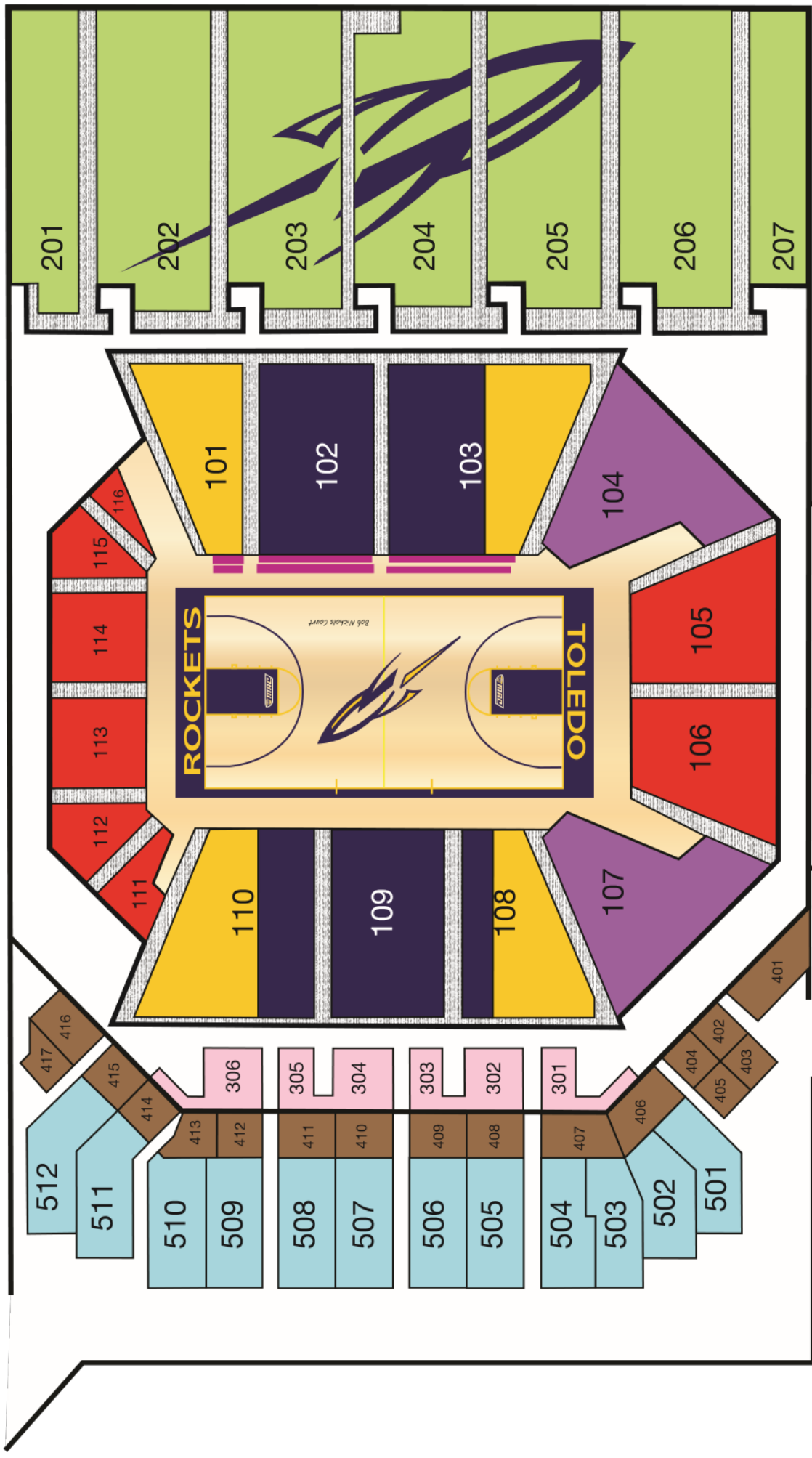

Grogan Room

# CONCERT SEATING

↖ To Ticket Office

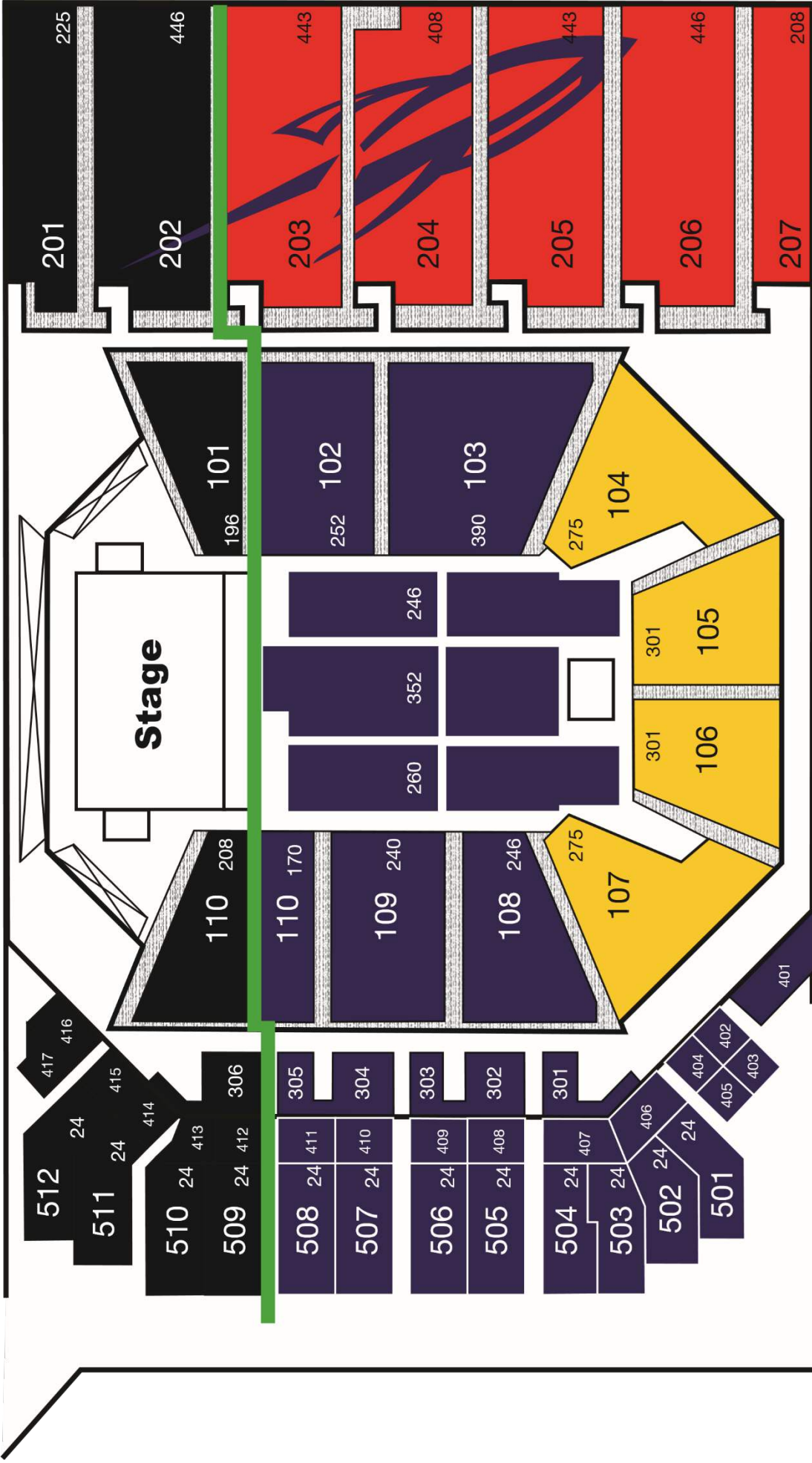

Grogan Room



# Dressing Rooms

## Dressing Rooms (Backstage / stage right)

3 large star dressing rooms with restroom and shower facilities:

- Star Dressing Room #1 - 920 sq ft
- Star Dressing Room #2 - 879 sq ft
- Star Dressing Room #3 - 1319 sq ft

5 additional dressing rooms

- Room #1 - 164 sq ft
- Room #2 - 163 sq ft
- Room #3 - 260 sq ft
- Room #4 - 180 sq ft
- Room #5 - 362 sq ft

### Dressing Room Specs

- All Dressing rooms area has wireless internet
- All star dressing rooms have wired internet drops
- All star dressing rooms have hard-line phone drops
- Dressing rooms 3 & 4 have hard-line phone and wired internet drops

### Dressing rooms furniture assets

- Couches
- Lounge chairs
- Tables (built-ins and portables)
- Mirrors

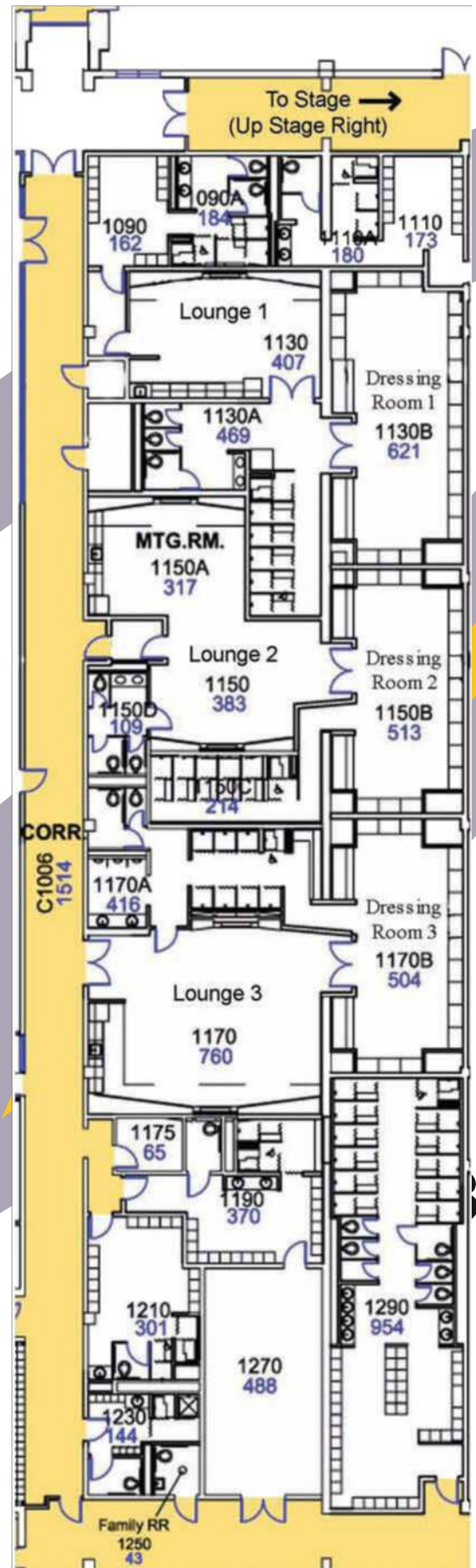

# Media

---

## Radio

92.5 KissFM  
125S. Superior St.  
Toledo, Oh 43604  
Office (419) 244-8321

93.5 WRQN  
3225 Arlington Ave.  
Toledo, Oh 43614  
Business Office (419) 725-5700

99.9 K100  
3225 Arlington Ave.  
Toledo, Oh 43614  
Business Office (419) 725-5700

101.5 The River  
125S. Superior St.  
Toledo, Oh 43604  
Business Office (419) 244-8321

104.7 WIOT  
125S. Superior St.  
Toledo, Oh 43604  
Business Line (419) 244-8321

## Television

CBS  
WTOL  
<http://www.wtol.com/>

ABC  
13 ABC  
<http://www.13abc.com/>

NBC  
NBC24  
<http://www.wnwo.com>

FOX  
FOX Toledo  
<http://www.foxtoledo.com/>

WGTE  
Public Broadcast Service  
<http://www.wgte.org/>

## Newspapers

The Blade  
541N. Superior St.  
Toledo, Oh 43660  
(419) 724-6000

Toledo City Paper  
Adams Street Publishing Co.  
1120 Adam St.  
Toledo, Oh 43604  
(419) 244-9859

Toledo Free Press  
605 Monroe Street  
Toledo, Oh 43604  
(419) 241-1700