

# **BJCC CONCERT HALL**

## **TECHNICAL GUIDE**



**BIRMINGHAM, ALABAMA**

# TABLE OF CONTENTS

<b>STAFF DIRECTORY</b>	.	.	.	.	.	.	.	.	.	<b>4</b>
<b>ADDRESS</b>	.	.	.	.	.	.	.	.	.	<b>5</b>
<b>PARKING MAP</b>	.	.	.	.	.	.	.	.	.	<b>6</b>
<b>TICKETING</b>	.	.	.	.	.	.	.	.	.	<b>7</b>
<b>LOADING</b>	.	.	.	.	.	.	.	.	.	<b>8</b>
<b>BACK OF HOUSE, STAGE HOUSE</b>	.	.	.	.	.	.	.	.	.	<b>9</b>
<b>TECHNICAL INFORMATION</b>	.	.	.	.	.	.	.	.	.	<b>10</b>
POWER, LIGHTING	.	.	.	.	.	.	.	.	.	10
AUDIO, INTERNET	.	.	.	.	.	.	.	.	.	11
<b>KEY PLANS</b>	.	.	.	.	.	.	.	.	.	<b>12</b>
CONCERT HALL DECK	.	.	.	.	.	.	.	.	.	12
STAGE FLOOR PLAN	.	.	.	.	.	.	.	.	.	13
SECOND FLOOR PLAN	.	.	.	.	.	.	.	.	.	14
BASEMENT CHORUS DRESSING ROOMS	.	.	.	.	.	.	.	.	.	15
CROSS SECTION THEATER AREA	.	.	.	.	.	.	.	.	.	16
LIGHTING PLAN	.	.	.	.	.	.	.	.	.	17
<b>EQUIPMENT</b>	.	.	.	.	.	.	.	.	.	<b>18</b>
<b>OTHER CHARGES</b>	.	.	.	.	.	.	.	.	.	<b>19</b>
<b>POLICIES &amp; GUIDELINES</b>	.	.	.	.	.	.	.	.	.	<b>20</b>
<b>ABOUT THE BJCC</b>	.	.	.	.	.	.	.	.	.	<b>22</b>

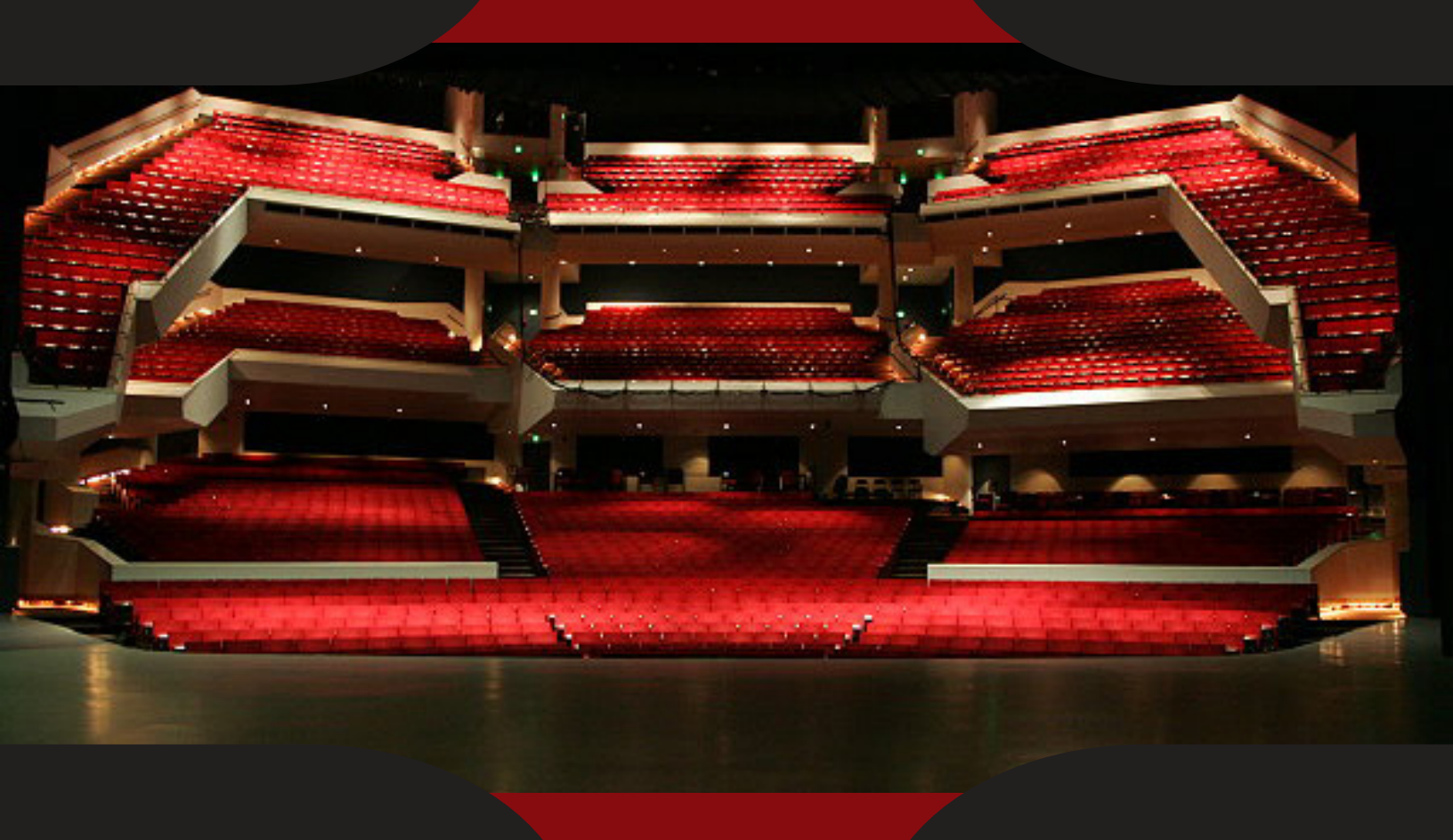

## BJCC CONCERT HALL

2,835-capacity theatre hosting national and regional touring concerts as well as serving as the home of Broadway in Birmingham, which brings top Broadway productions to Birmingham every year. The Concert Hall is also used for a variety of community events including dance recitals and singing competitions.

*It's nice*  
TO HAVE YOU IN  
**BIRMINGHAM**



# STAFF DIRECTORY

## DIRECTOR OF EVENTS

Bobby Breedlove

[bobby.breedlove@bjcc.org](mailto:bobby.breedlove@bjcc.org)

205.623.9589

## PRODUCTION MANAGER

Spencer Webb

[spencer.webb@bjcc.org](mailto:spencer.webb@bjcc.org)

205.458.8551

## EVENT MANAGER

Zoe Clark

[zoe.clark@bjcc.org](mailto:zoe.clark@bjcc.org)

205.458.8544

## SR DIRECTOR OF SALES & MARKETING

Nicole Klein

[nicole.klein@bjcc.org](mailto:nicole.klein@bjcc.org)

205.458.8441

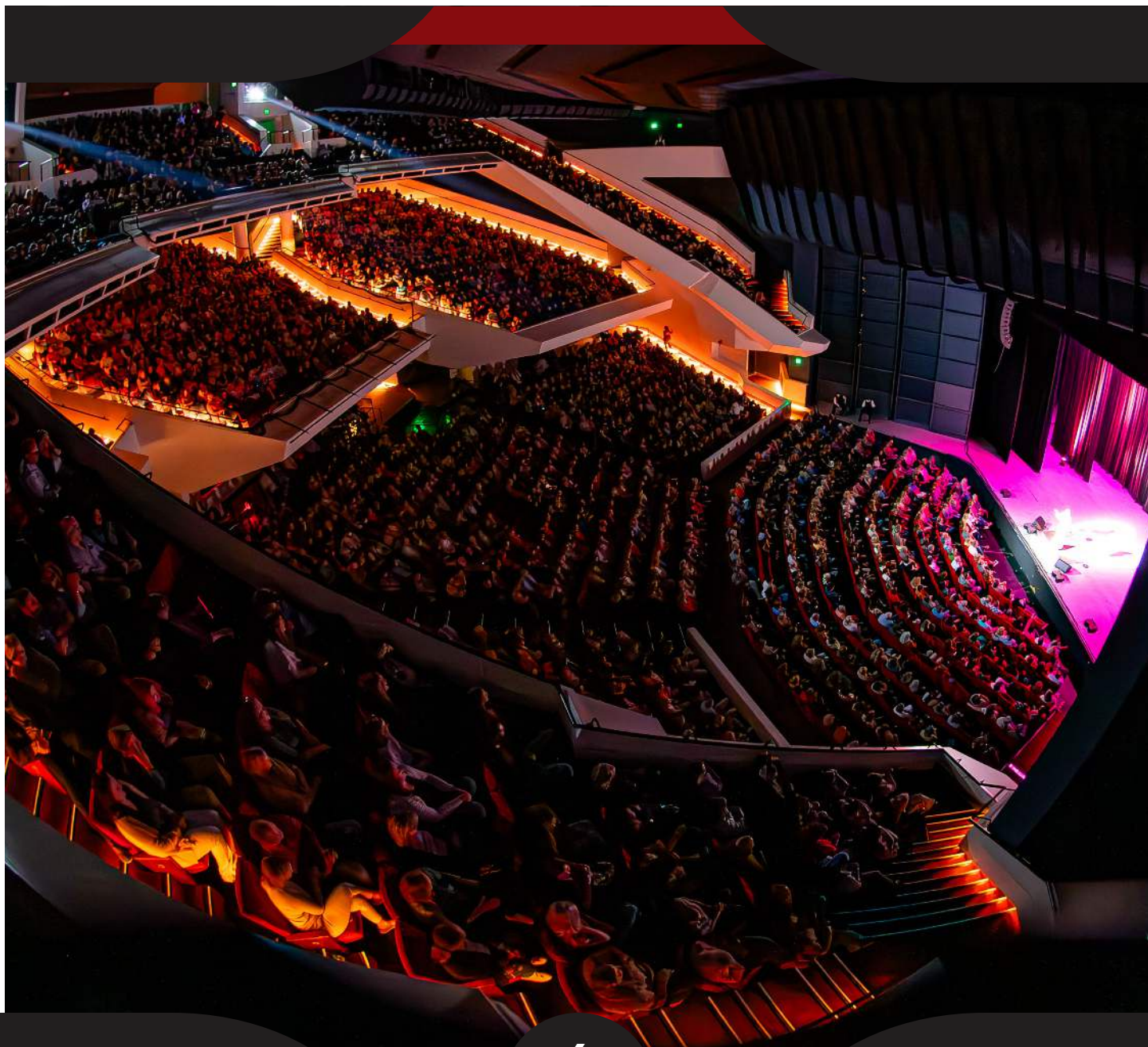



# ADDRESS

## MAILING ADDRESS

Birmingham - Jefferson Convention Complex, Concert Hall, Dock 2  
2100 Richard Arrington Jr. Blvd. N  
Birmingham, AL 35203

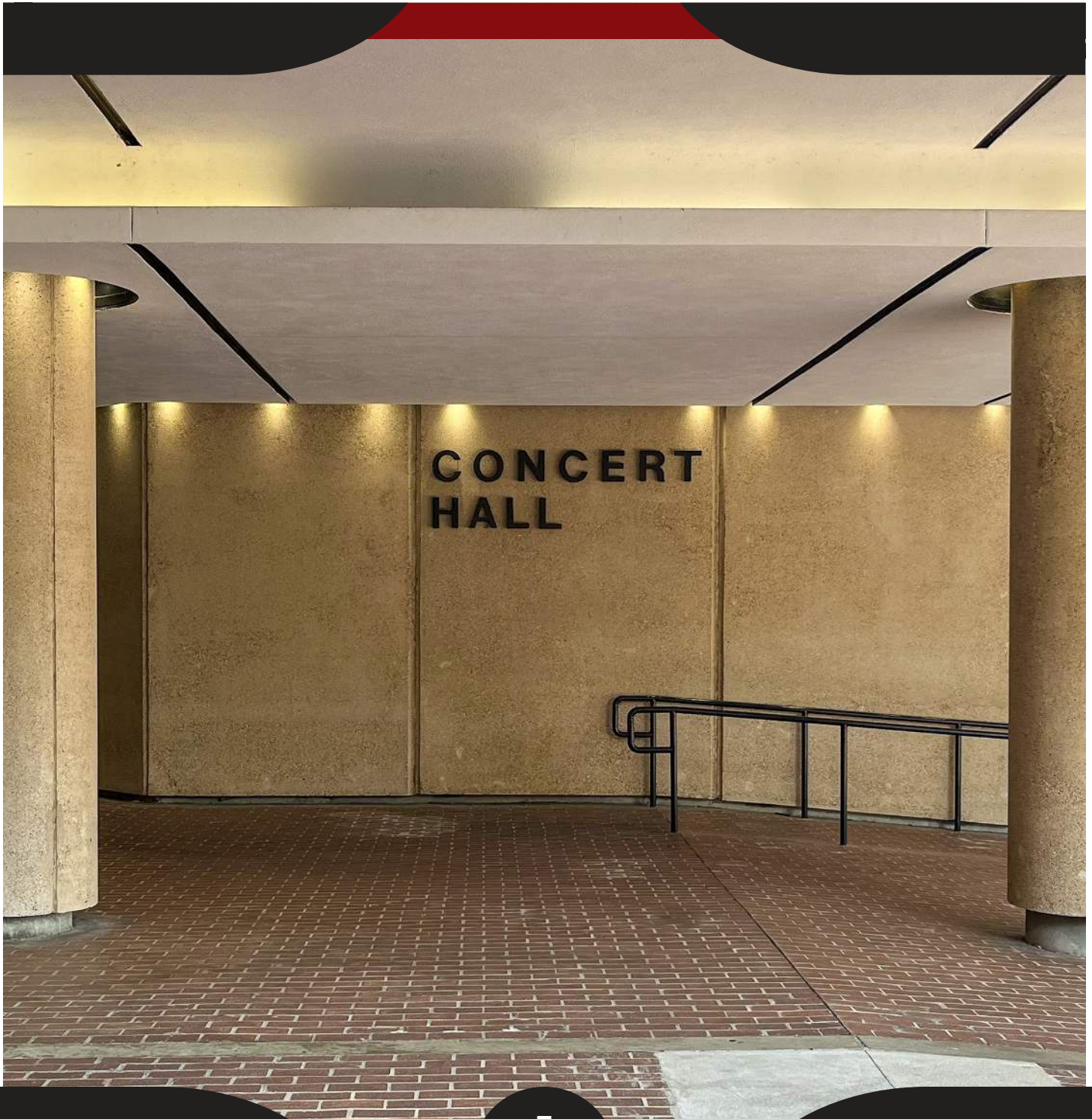

# PARKING MAP

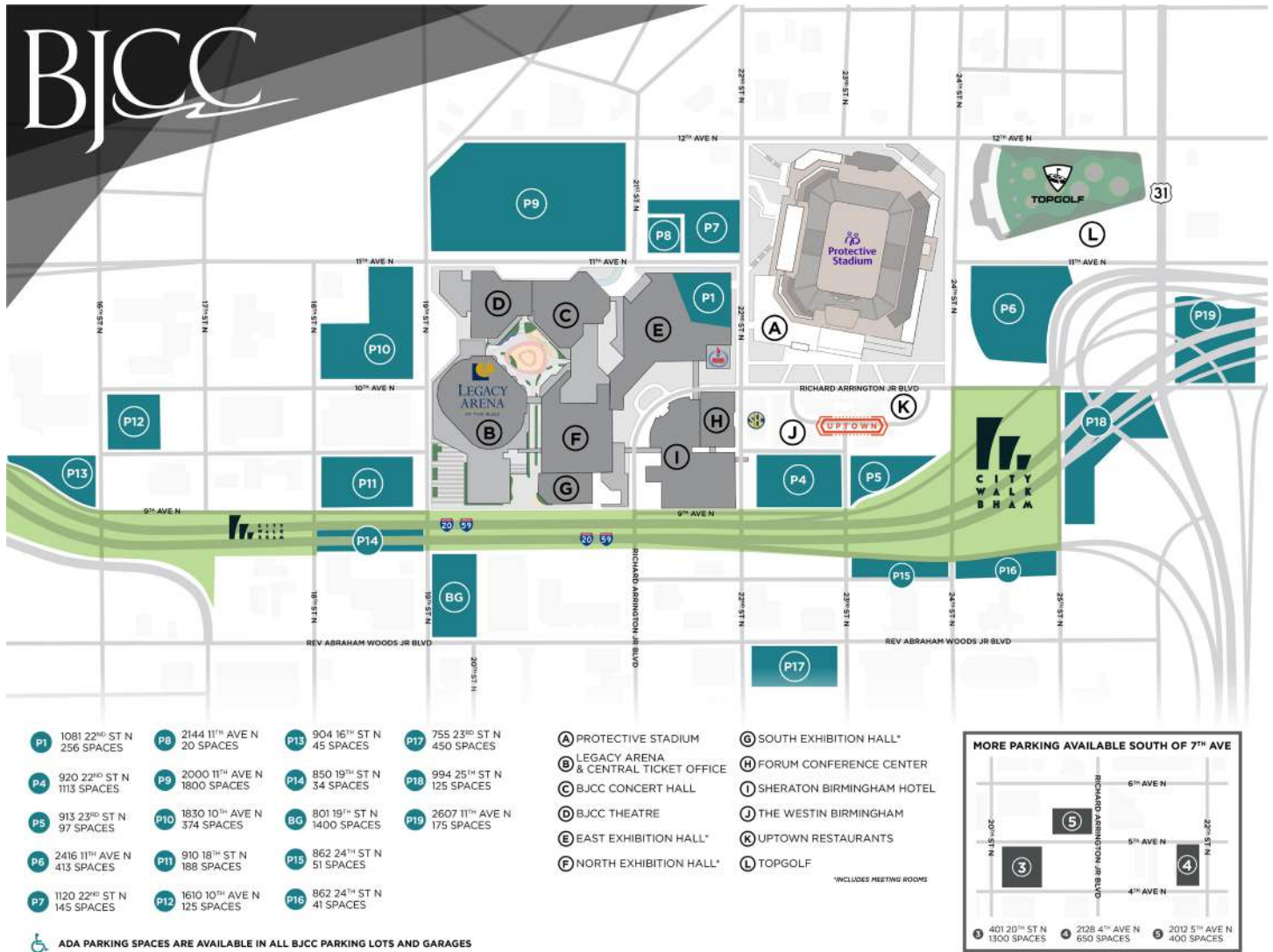



# TICKETING

## TICKETMASTER:

The BJCC Concert Hall exclusively uses Ticketmaster as its ticketing platform for all complex events. No other ticketing company or third party can be used to sell tickets on behalf of the Licensee through outlets, internet, phone or otherwise. Ticketed events held at the BJCC Concert Hall will utilize Ticketmaster and be serviced by the BJCC Box Office staff including all applicable fees as set forth in the rental agreement.

## BOX OFFICE:

The BJCC maintains a Central Ticket Office for daily in-person sales at Legacy Arena located at 1898 9th Ave. N, Birmingham, AL 35203. The BJCC Concert Hall box office, located directly adjacent to the Hall's main entrance, opens two hours prior to Concert Hall events.



**CENTRAL TICKET OFFICE**

# LOADING

## LOCATION:

**LOADING DOOR:** 12' h x 15'8" w

**TRUCKS:** (2) at same time; side by side

**LOADING DOCK:** Dock is at truck level; loading to stage through separate scene shop.

# CAPACITY

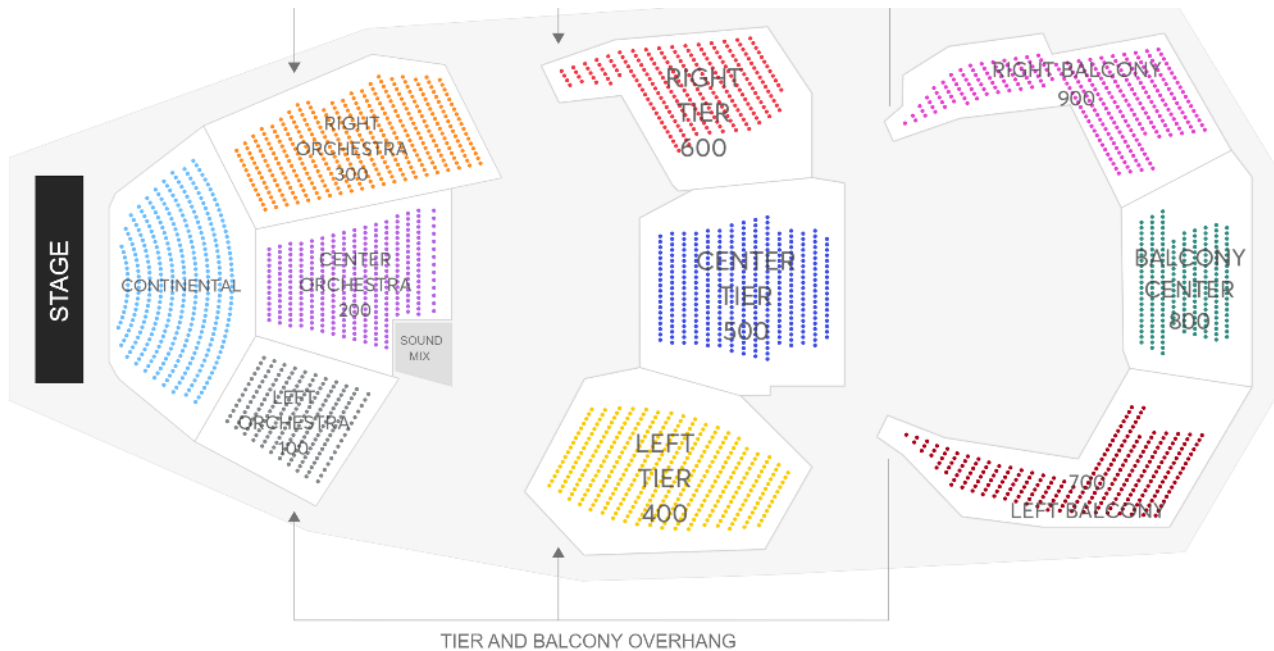

Price Level	Base Price	Total Capacity	Kills	Sellable Capacity	Total
P1	-	343	0	343	\$0.00
P2	-	375	0	375	\$0.00
P3	-	297	0	297	\$0.00
P4	-	185	0	185	\$0.00
P5	-	225	0	225	\$0.00
P6	-	334	0	334	\$0.00
P7	-	349	0	349	\$0.00
P8	-	285	0	285	\$0.00
P9	-	194	0	194	\$0.00
P10	-	248	0	248	\$0.00
<b>Total</b>	<b>Avg / seat: \$0.00</b>	<b>2,835</b>	<b>0</b>	<b>2,835</b>	<b>\$0.00</b>



# BACK OF HOUSE

## WARDROBE:

<b>LOCATIONS:</b>	Stage Left on Stage Level
<b>ACCESS:</b>	Direct from Stage
<b>FACILITIES:</b>	3 Washers & 3 Dryers on dock Stage Right

## DRESSING ROOMS:

<b>STAR ROOMS (4):</b>	Bath & Shower included. Stage Left on Stage Level.
<b>SMALL ROOMS (6):</b>	Bath & shower included. Stage Left on 2nd Floor.
<b>CHORUS ROOMS (2):</b>	Bath & shower included. Stage Left in Basement.

## STORAGE & REHEARSAL AREAS:

<b>STORAGE SPACE:</b>	Over 50' of excess wing space on either side of stage.
<b>REHEARSAL SPACE:</b>	(2) rooms, roughly 60' x 30' each. Piano is available; prior arrangements required.

# STAGE HOUSE

## FLY SYSTEM:

<b>HOUSE CURTAIN:</b>	Single purchase operates as traveler from Stage Right deck. Does not guillotine.
<b>WEIGHT:</b>	30,000 lbs. available
<b>LINE SETS:</b>	70 Double purchase line sets at 6" +/-O.C. with 7 lift lines per set
<b>ARBORS:</b>	1200 lbs. Capacity
<b>HOUSE PIPES:</b>	70' long with 90' of travel from deck

**Elevated Fly Rail Stage Left. Pin Rail located Stage Left and Stage Right.**

## PERMANENT INSTALLATIONS:

<b>OVER STAGE:</b>	4 Border Light Electrics 4 Orchestra Shells 2 Travellers
<b>ON DECK:</b>	4-Columns 18" square at 59'8" located (2) 28'0" SR & SL of center (2) in SR & SL wings Manlift enclosure located at 56'8" located 56'0" SR of center
<b>ORCHESTRA PIT:</b>	Adjustable to 35 ft. below stage level by hydraulic lift. Pit lifts in 2 sections.

# TECHNICAL INFORMATION

## POWER

### ELECTRICS:

PANEL	PHASE	AMP	CIRCUIT	USE	LOCATION
A	3	400	FUSE	EXTRA	DSR Proscenium Wall
B	3	400	FUSE	EXTRA	DSR Proscenium Wall
C	3	400	FUSE	EXTRA	DSR Proscenium Wall
D	3	400	BREAKER	SOUND	DSR Proscenium Wall
E	3	200	BREAKER	SOUND	DSR Proscenium Wall
F	3	100	BREAKER	SOUND	DSL Proscenium Wall

*All service panels located within 50' of stage area*

POSITION	PIPE WIDTH	DISTANCE TO PROSCENIUM	LINESET NUMBER	DIMMING CIRCUITS	CONNECTOR TYPE
FRONT OF HOUSE					
1ST BALCONY RAIL	35'	90'	-	12	L5-20
1ST COVE	100'	40'	-	34	L5-20
2ND COVE	100'	66'	-	26	L5-20
BOX BOOM	-	18'	-	14*	L5-20
OVER STAGE					
MOTOR LX	70'	4'4"	-	24	L5-20
1ST LX	70'	8'0"	#13	24	L5-20
2ND LX	70'	15'11"	#29	24	L5-20
3RD LX	70'	23'11"	#45	24	L5-20
4TH LX	70'	32'5"	#61	24	L5-20
5TH LX	70'	40'2"	#77	24	L5-20
CYC LX	70'	42'4"	#81	24	L5-20
PIN RAIL	-	-	-	4*	L5-20
ONSTAGE	-	-	-	14*	L5-20

*\*Number for each side of stage*

## LIGHTING

### HOUSE LIGHTING:

**HOUSE FOLLOWSPOTS:** (4) Lycian 1290 XLT

**FOLLOWSPOT BOOTHS:** (2) Booths with a maximum of (2) spots per booth  
110' throw to Proscenium

**BOOTH POWER:** (4) Single phase, 30A 120VAC

# AUDIO

## HOUSE SOUND SYSTEM:

**CONSOLE:** Yamaha MG32/14fx  
**SPEAKERS:** House Cluster - EAW  
**COMMUNICATIONS:**

Intercom System: Clear - Com  
Hearing Impaired: Williams sound  
Dressing Room: Page System

## ROAD CONSOLE MIX:

Position: Located in rear of house.  
Cable run from SR is 200'.  
Tie-in into house system with XLR connectors.

# INTERNET

## INTERNET CONNECTIVITY:

The BJCC Concert Hall provides in-house information technology and telecommunications support. The BJCC's infrastructure supports connection speeds up to one gigabyte. Services can be accessed via CAT6 UTP and wireless connectivity exist throughout the complex.



# KEY PLANS

## CONCERT HALL DECK

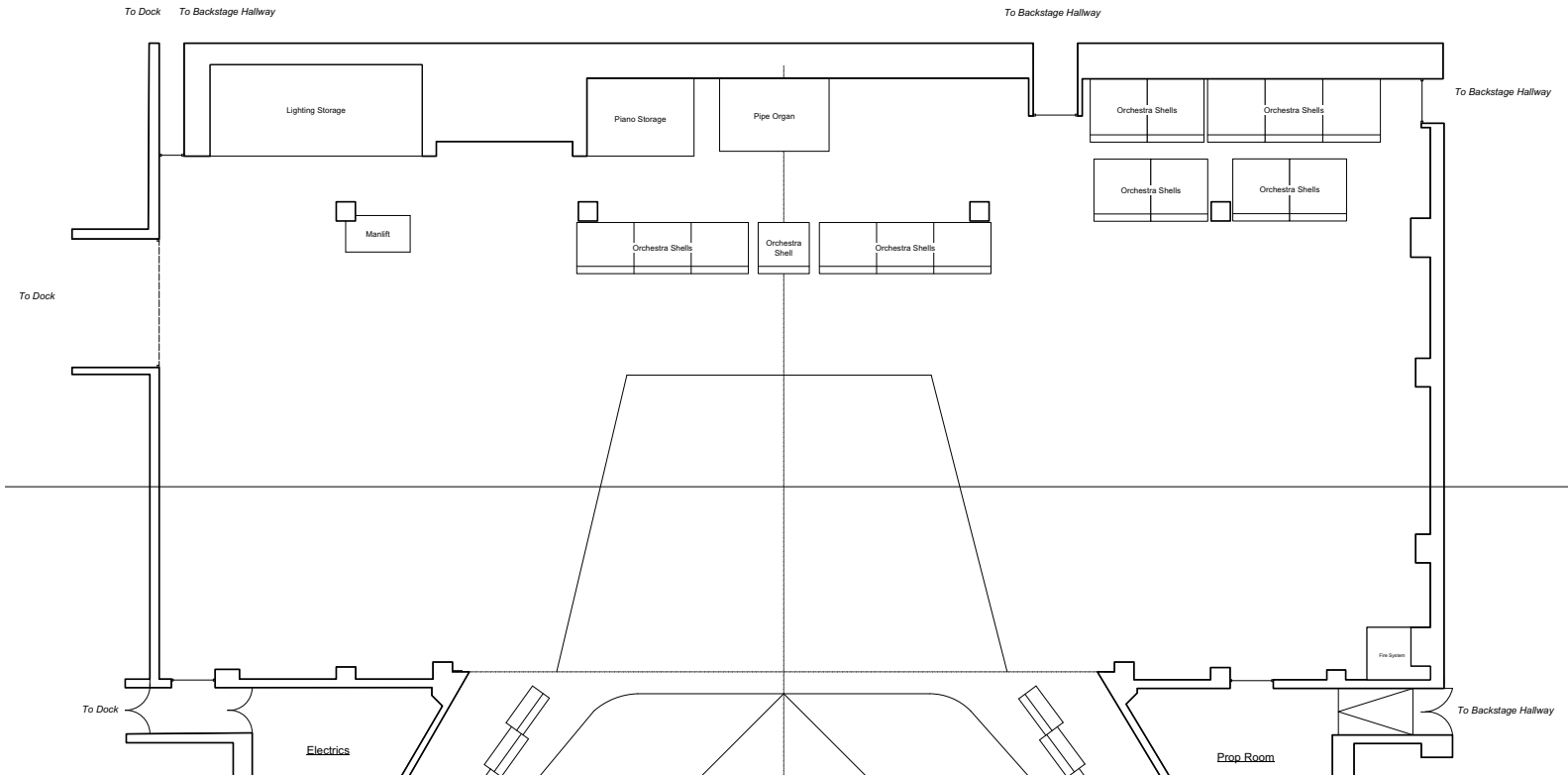

Enlarged plans available upon request.



## SECOND FLOOR PLAN

Enlarged plans available upon request.

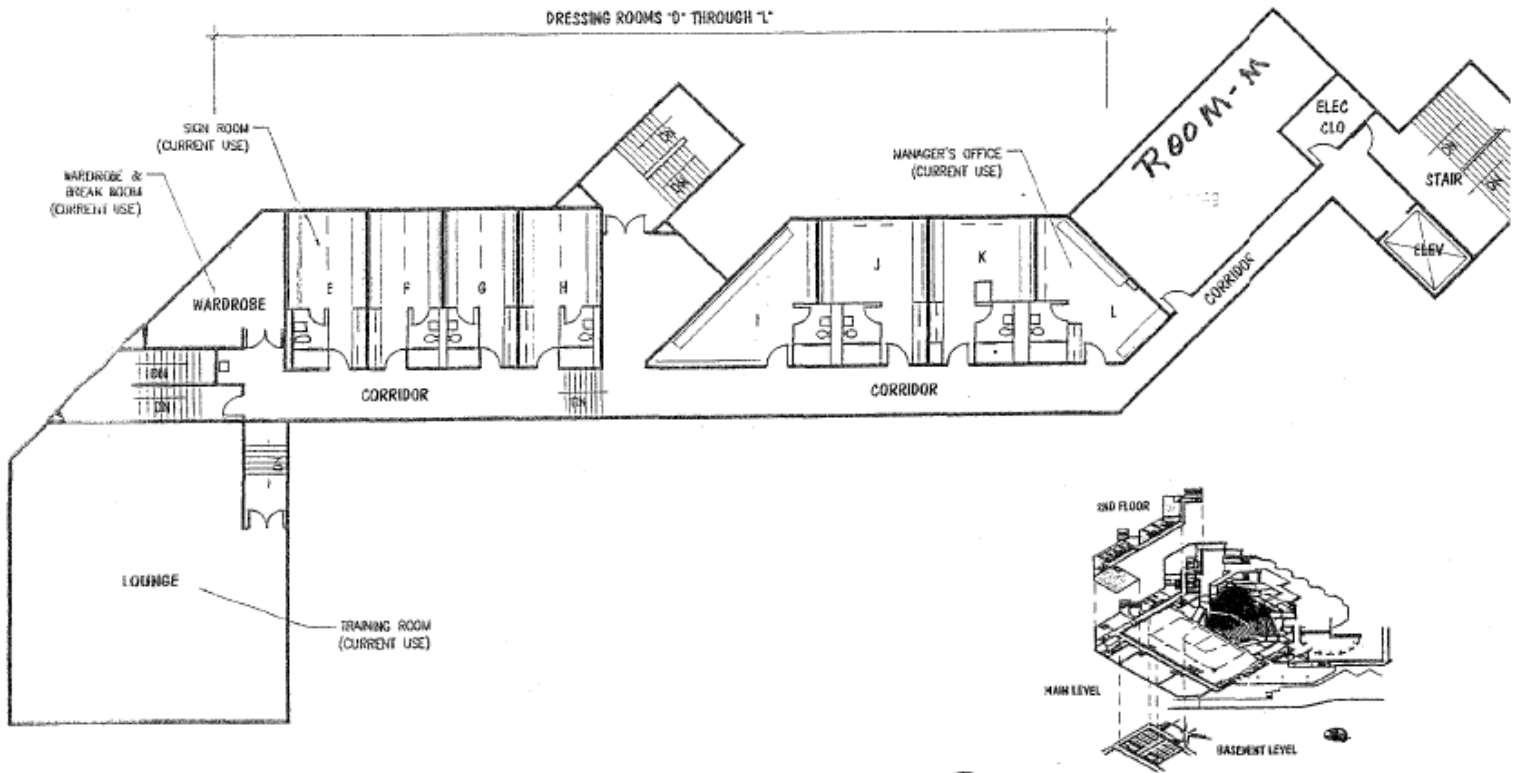



## BASEMENT CHORUS DRESSING ROOMS

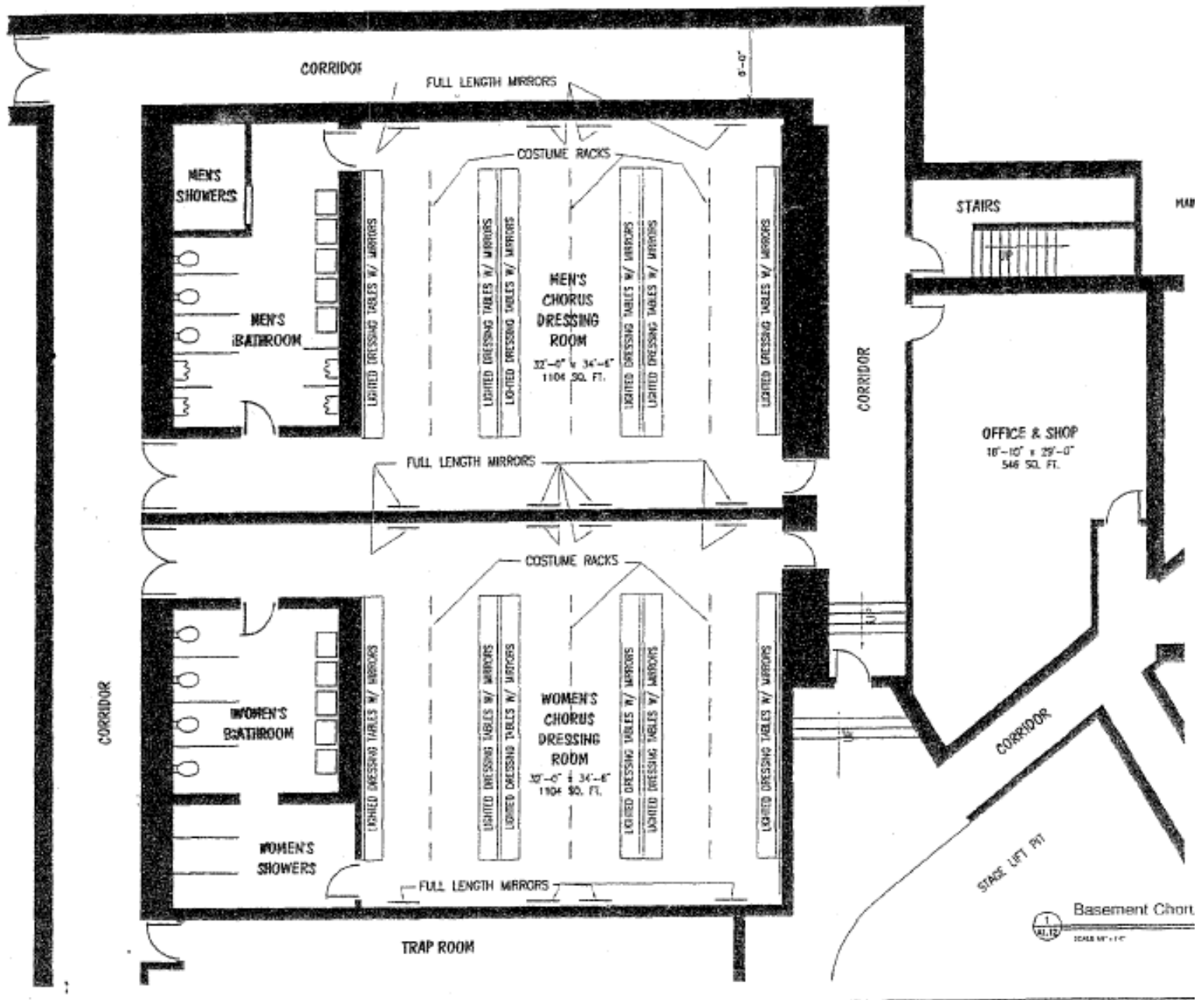

## 16



## 17





# EQUIPMENT

## EQUIPMENT RENTAL:

<b>1 Washer and 1 Dryer</b>	\$50 per day
<b>Jiffy 1421 J4000M Pro Line Steamer</b>	\$75.00 Each One day use
<b>Bath Towels</b>	\$4.25 each
<b>Stage (hand) towels</b>	\$3.00 each
<b>High Speed Internet Hard Line</b>	\$300.00 per show
<b>High Speed Internet Hard Line Addi.</b>	\$100.00 each
<b>High Speed Internet WIFI</b>	\$150.00 per show
<b>High Speed Internet WIFI Addi. Code</b>	\$75.00 each
<b>Telephone Lines</b>	\$150.00 first line
<b>Telephone Lines</b>	\$135.00 each additional line
<b>Telephone Unit</b>	\$20.00 each
<b>Long Distance Calls</b>	10 Cents per Minutes
<b>House Sound System Rental</b>	\$250.00 per day
<b>House Lighting System Rental</b>	\$250.00 per day
<b>Spotlight</b>	\$75.00 each per day
<b>Microphone Wired</b>	\$35.00 each per day
<b>Microphone Wireless</b>	\$125.00 each per day
<b>ClearCom</b>	\$25.00 each per day
<b>Music Stand and Light (50 available)</b>	\$10.00 each per day including light
<b>Holes Repair (Stage)</b>	\$25.00 each
<b>Water 5 Gallons Container</b>	\$20.00 per 5 gal. Container
<b>Water Coolers</b>	\$50.00 per Cooler
<b>Water Cups</b>	1500@ \$125.00
<b>Sofa and Love Seat / Living Room Set</b>	\$350.00
<b>Steinway Grand Piano</b>	\$375.00 per day - \$650.00 per Week+ tuning
<b>Piano Tuning</b>	\$295.00 per Tuning
<b>Yamaha Upright Piano Rental</b>	\$275.00 per day - \$500.00 Per Week
<b>Schlicker Pipe Organ - ( 800 Pipes)</b>	\$550.00 Per day-\$ 1100.00 per Week
<b>Organ Tuning</b>	\$575.00 per tuning

## REPLACEMENT CHARGES:

<b>IRON</b>	\$35.00 each
<b>IRONING BOARD</b>	\$35.00 each
<b>IRONING BOARD COVER</b>	\$25.00 each
<b>TABLECLOTH</b>	\$100.00
<b>TABLE SKIRT</b>	\$200.00

ALL PRICES ARE SUBJECT TO CHANGE WITHOUT NOTICE

## OTHER CHARGES

### FIRE MARSHAL PERMIT & LABOR:

<b>FIRE MARSHAL</b>	\$300.00 - Four Hour Minimum \$50.00 - Each Additional Hour
<b>BJCC FIRE ALARM CONTROL SWITCHER</b>	\$200.00 - Four Hour Minimum \$50.00 - Each Additional Hour
<b>FIRE PERMIT</b>	\$75.00 - First Show \$75.00 Each / \$25.00 Each Additional Show

### LICENSE & TAX:

<b>BIRMINGHAM BUSINESS LICENSE TAX</b>	\$200.00 per Performance
<b>JEFFERSON COUNTY BUSINESS LIC. TAX</b>	\$50.00 Flat Fee
<b>ALABAMA BUSINESS LIC. TAX</b>	\$16.50 Per Performance
<b>LOCAL SALES TAX</b>	10% Fee in Lieu of Sales Tax
<b>CREDIT CARD CHARGES</b>	3% of PBO credit card charges

# **POLICIES & GUIDELINES**

The BJCC Concert Hall, as a facility within the Birmingham-Jefferson Convention Complex (BJCC) is owned and managed by the Birmingham-Jefferson Civic Center Authority.

While your Event Manager is available to clarify any specific policies and guidelines, some of our most referenced policies are listed below.

## **EVENT STAFFING:**

The BJCC strives to maintain a friendly and safe environment for its guests. To achieve this level of service, minimum staffing levels are required for both ticketed and non-ticketed events that will be contracted for and supervised by the BJCC. Your Event Manager will work with you to determine the appropriate crowd management staffing model required to conduct a safe and secure event by evaluating event attendance, nature of event, show and venue history. Best Crowd Management is the exclusive provider of crowd management personnel. Fees for staffing are to be considered an event expense and the responsibility of the licensee.

## **PRODUCTION LABOR:**

Licensee, working in coordination and direction of the BJCC, must use labor provided by International Alliance of Theatrical Stage Employees (IATSE) Local 78 for show-related rigging and production needs.

## **SIGNAGE:**

Banners and signs are welcome in our facilities with advance approval from the BJCC. This includes, but is not limited to, exterior, interior, wayfinding, and entrance signage. Permanent facility signs and directional graphics may not be blocked. Signs must be placed on easels and not taped, tacked, or adhered to any other surface. Signage in the common spaces of the BJCC must be professionally printed or computer generated - no hand-written signs are permitted. Signs may not be placed in any complex elevator. Any damage by adhesive materials on floors, walls, or any BJCC property will incur charges. After an event, all posted signage must be removed, or a removal charge will be incurred.

## **SPONSORSHIPS:**

All sponsorships including signage, giveaways and other promotional items displayed or handed out on the BJCC Concert Hall property must be coordinated with your Event Manager. Due to some building exclusivities, certain sponsors may be precluded from displays inside the BJCC Concert Hall and on building property. Please contact your Event Manager for the most up-to-date list of BJCC Concert Hall protected advertisers and partnerships.

## **FOOD & BEVERAGE:**

All food and beverage to be consumed within the BJCC Concert Hall including catering, concessions, and alcohol service must be coordinated through the BJCC's exclusive partner, Sodexo Live!. Sodexo Live!, as the alcoholic beverage license holder, must enforce all applicable laws and codes in association with the sale and consumption of alcoholic beverages and during activities serving alcoholic beverages, uniformed law enforcement officers, at the expense of licensee, must be on-site. Permission to distribute or dispense, without charge, samples of food, beverages, refreshments, sundries related to an event, etc. shall be arranged in advance and be clearly stated and identified as "further terms and conditions" to the Lease Agreement.

## **PYROTECHNICS:**

All pyrotechnic effects must be approved by the BJCC and then permitted through Birmingham Fire and Rescue and State of Alabama as required. Birmingham Fire and Rescue's Fire Marshall division can be reached at (205) 250-7540 for any questions regarding the permitting processes, licenses, and fees required.

## **CONFETTI:**

With advanced review and approval from the BJCC including the Director of Event Management, confetti may be used. Confetti should be made from a water-soluble paper source and be a minimum of 1" x 1" in size. Absolutely no mylar material or glitter shall be used in any confetti display. A minimum clean-up charge shall be assessed for the use of confetti.



# ABOUT THE BJCC

Located in the heart of the Uptown Entertainment District, the Birmingham Jefferson Convention Complex is more than just a venue for conventions and trade shows, it is a magnet for the local community, too. As one of the city's premier gathering places, it is where Best in Class sporting events, concerts, Broadway shows, local meetings, galas, educational seminars, cultural, religious, and social events take place on a daily basis.

On the BJCC campus, you will find everything you need for your event, starting with an array of top-notch facilities, 791 guest rooms in our Westin Birmingham and Sheraton Birmingham Hotels, convenient dining and entertainment as well as helpful event staff and a host of specialized services. The complex offers over 420,000 sq. ft. of flexible meeting space, 88 breakouts and 18 unique venues all in one walkable location.

2100 Richard Arrington Junior Blvd. N  
Birmingham, AL 35203

Visit the BJCC's website for more information by clicking [here](#).



## EAST EXHIBITION HALL

92,234 sq. ft. Exhibition Space  
22 Meeting Rooms  
Largest Room 14,193 sq. ft.  
1850 Capacity

## NORTH EXHIBITION HALL

94,269 sq. ft. Exhibition Space  
11 Meeting Rooms  
Largest Room 9,574 sq. ft.  
432 Capacity

## SOUTH EXHIBITION HALL

21,182 sq. ft. Exhibition Space  
10 Meeting Rooms  
Largest Room 14,530 sq. ft.  
1440 Capacity

## THE FORUM CONFERENCE CENTER

3,750 sq. ft. Theater  
12 Meeting Rooms  
Largest Room 7,280 sq. ft.  
480 Capacity

## BJCC CONCERT HALL

2,835 Capacity  
2 chorus rooms and 12 dressing rooms as well as 2 rehearsal areas and a VIP Reception Room.

## BJCC THEATRE

1000 Capacity  
2 rehearsal areas, 7 dressing rooms total, including 2 chorus rooms, 2 star dressing rooms, and 3 other dressing rooms.



## **SHERATON BIRMINGHAM HOTEL**

2100 Richard Arrington Jr. Blvd. N  
Birmingham, AL 35203

Sheraton Birmingham Hotel is a luxurious property with modern amenities and spacious, newly renovated guest rooms. Showcasing nearly 43,000 sq. ft. of event space, a total of 20 function rooms are available for private rental.

Visit the Sheraton's [website](#).

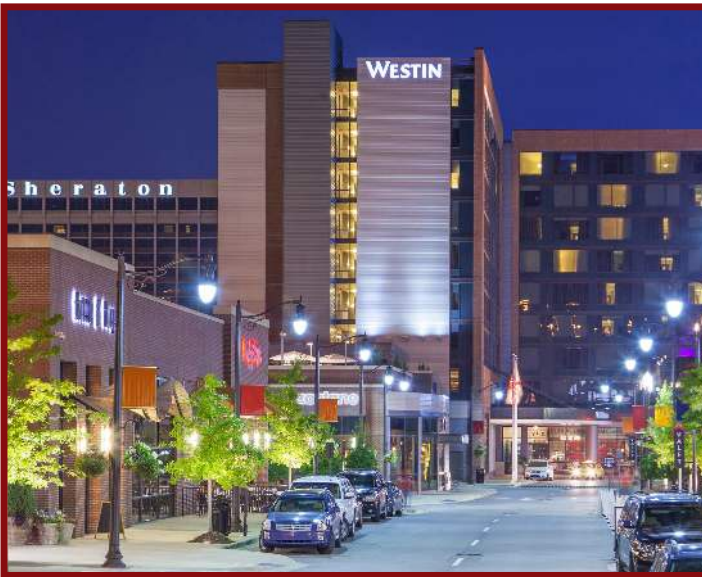

## **THE WESTIN BIRMINGHAM**

2212 Richard Arrington Jr. Blvd. N  
Birmingham, AL 35203

The Westin Birmingham is a AAA 4-Diamond approved hotel. Offering 294 contemporary and stylish sleeping rooms, the Westin can accommodate up to 340 meeting attendees in a theater configuration. State-of-the-art technology and high-speed internet access is available in all meeting rooms.

Visit the Westin's [website](#).



## **LEGACY ARENA**

1898 9th Ave. N.  
Birmingham, AL 35203

The newly modernized 18,000-capacity arena stands ten-stories high and hosts national and international touring concerts, productions, and a variety of sporting events each year. The arena has a curtaining system that allows the space to scale to a 6,200-capacity theater, and is available for private events of all types.





## **PROTECTIVE STADIUM**

1101 22nd St. North  
Birmingham, AL 35203

The 45,000-capacity multi-purpose, open air stadium hosts large concerts, private functions, and a variety of sporting events year round. The 11,500 sq. ft. Stadium Club with views of the playing field and 6,400 sq. ft. Recruiting Room looking out to the Uptown Entertainment District are also available for rental. The Stadium is an ideal venue to host kick-off/closing events and VIP experiences.



## **CITY WALK BHAM**

Covering 31 acres and 10 city blocks, City Walk offers 10 unique outdoor spaces that will accommodate almost any type of event. The venue includes recreational sports facilities, an amphitheater and classroom and a variety of open flexible spaces. City Walk BHAM is an ideal outdoor venue for kick off and closing parties, receptions, team building or other corporate gatherings.

Visit City Walk BHAM website for more information by clicking [here](#).